

Ladybird

Group 1, 2, 3, Car Seat

Suitable for 9kg to 36 kg
(approximately 9 months to 11 years)

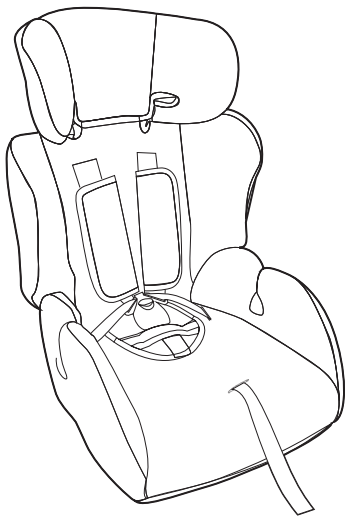

Model: JC1206

PARTS AND FITTINGS

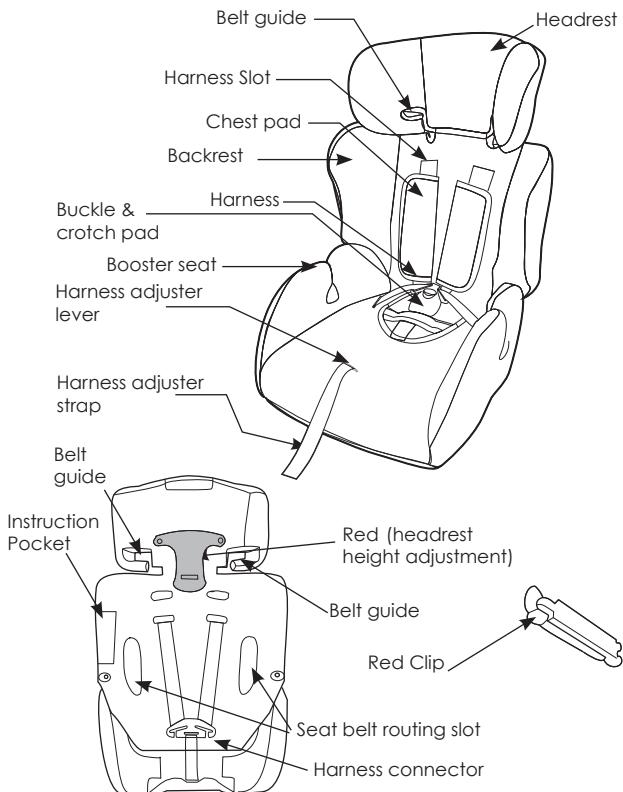

ATTACHING THE BACKREST TO THE BOOSTER SEAT

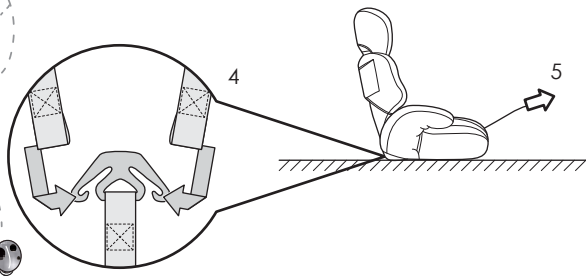
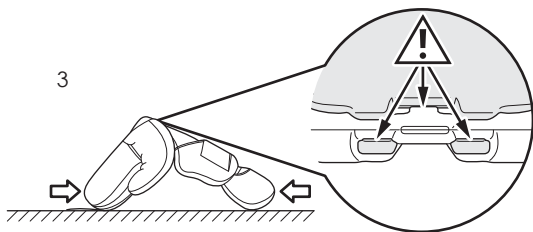
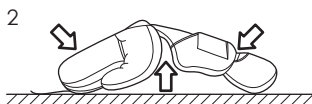
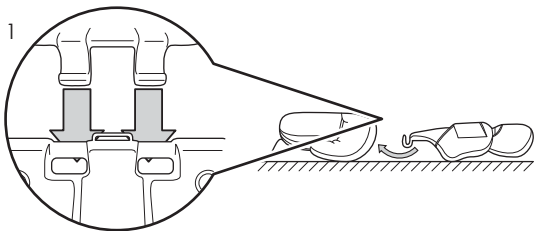

CORRECT SHOULDER STRAP HEIGHT

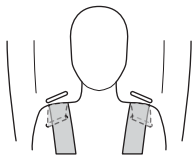

No — Too Low

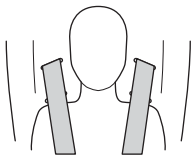

No — Too High

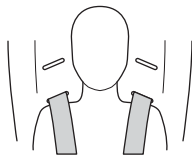

Yes — Correct

CHANGING THE SHOULDER STRAP HEIGHT

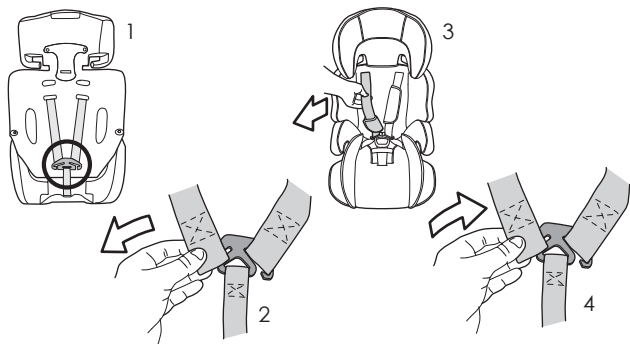

Locate the harness connector on the rear of the car seat. Slide one of the harness straps off the harness connector (1).

From the front of the seat, pull it through the slot in the seat backrest and fabric cover (2).

Thread the harness strap back through the next slot up or down on the cover and backrest (3).

Re-thread the harness strap back onto the harness connector at the back of the seat (4).

Repeat for the other harness strap. Ensure both straps are at the same height.

FASTENING THE SAFETY SEAT BUCKLE

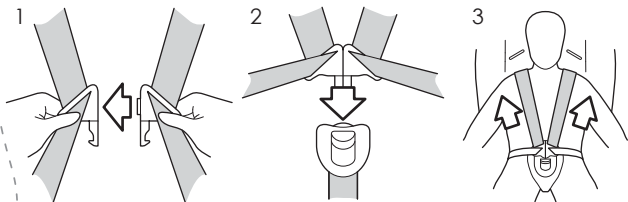

Slot the two metal sections of the buckle connectors together (1).

Slot the two buckle connectors into the slot in the top of the buckle until they “click” into place (2).

Always check the harness is correctly locked by pulling the shoulder straps upwards (3).

To release the harness, press the red button on the buckle downwards.

TIGHTENING THE HARNESS

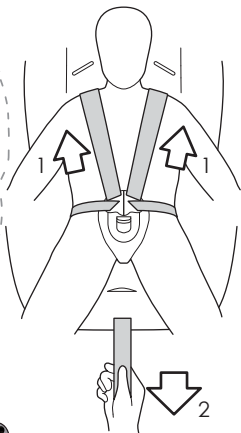

Pull the shoulder straps upwards to remove the slack from the lap sections of the harness (1). Now pull the adjuster strap until the harness is fully tightened (2).

The harness should be adjusted as tightly as possible without causing discomfort to your child.

Ensure that the lap strap portion of the harness is located as low as possible towards the thighs—not around the tummy.

A loose harness can be dangerous. Check the harness adjustment and tighten each time the child is placed in the seat



SLACKENING THE HARNESS

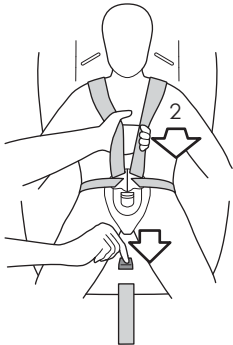

The harness is slackened by pressing the lever (under the seat cover) on the front of the seat.

Whilst gripping the two shoulder straps with your other hand, press down the lever (1) and pull the shoulder straps towards you to loosen the harness (2).

Take care when adjusting the shoulder straps that you do not trap the harness adjuster straps as you press the lever down.

FITTING THE CAR SEAT WITH THE 3-POINT LAP AND DIAGONAL SEAT BELT 9 – 18KG (APPROXIMATELY 9 MONTHS TO 4 YEARS).



Place the child safety seat on the vehicles seat ensuring it is firmly pressed against the car seat backrest (1).

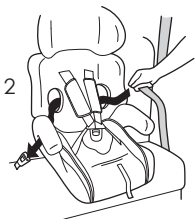

Thread the car seat belt through the seat belt route slot in the seats plastic backrest furthest from the cars seat belt buckle, and then out through the other seat belt route slot and fasten it into the seat belt buckle (2).

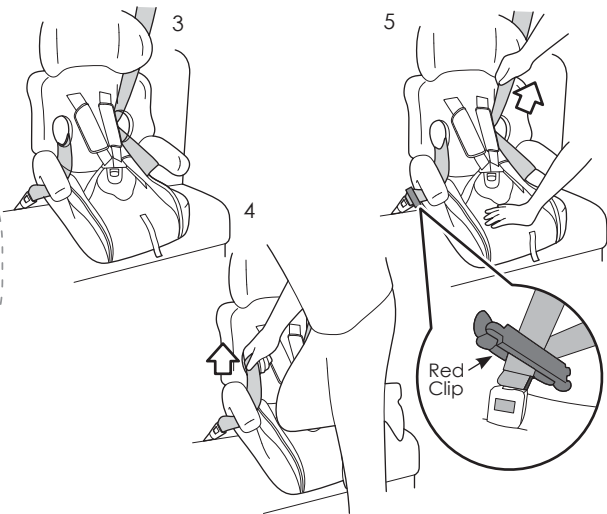

Check the webbing of the seat belt has not become twisted or tangled and that the lap belt goes under the armrest and the diagonal belt under the headrest belt guide then goes over the red belt guide on the side of the backrest (3).

Place your knee on the base of the safety seat and grip the top piece of the seat belt webbing. Pull the webbing upwards to tighten the seat belt (4).

Finish tightening the webbing by pulling the diagonal strap upwards until there is no slack and the seat is held firmly in place, attach the red clip to the diagonal belt near to the buckle (5).

Now you can strap your child into the seat. Make sure the seat belt has not become twisted. Also check that the cover is not impeding the movement or fit of the seat belt webbing in any way. To remove your child seat follow the above instructions in reverse order.



ADJUSTING THE HEADREST HEIGHT

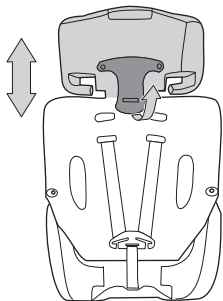

(According to the child's height) The headrest can be adjusted up or down.

Put your left (or right) hand on the backrest for support.

Pull the red headrest adjuster with your other hand.

Move the headrest up or down as required ensuring the position fits for your child.

REMOVING THE SAFETY HARNESS CROTCH STRAP

Important: Before fitting the seat remove the crotch straps and shoulder strap.

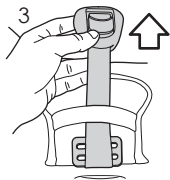
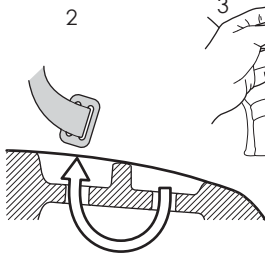
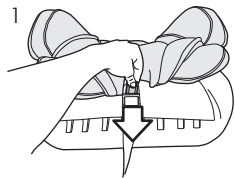

Pull the front of the seat cover upwards and slot the crotch strap buckle through the slot in the seat base (1).

Slot the buckle through the second slot in the base and through the slot in the cover (2).

Pull the crotch strap through the loop on the crotch pad (3).

REMOVING THE SAFETY HARNESS SHOULDER STRAPS

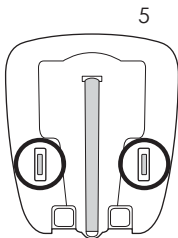
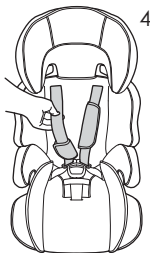
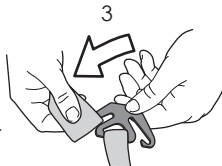
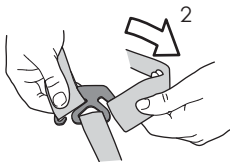
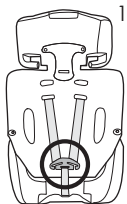

Locate the harness connector on the rear of the car seat (1).
Slide both the harness straps off the harness connector (2 & 3).
Pull the webbing through the slots in the seat backrest and fabric cover (4).

Locate the two webbing retainers on the underside of the seat (5).

Turn the webbing retainers on their narrowest end and feed them through the slots in the base of the seat, then through the slots in the fabric cover (6).

Place the crotch and shoulder straps in a safe place away from children.



FITTING THE CAR SEAT USING THE VEHICLES SEAT BELT 15 – 25KG (APPROXIMATELY 3 YEARS TO 11 YEARS).

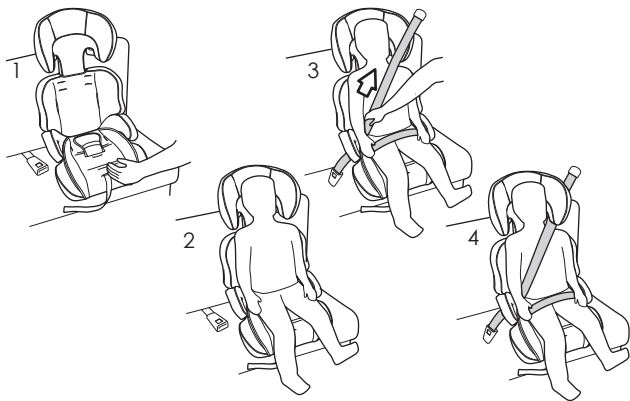

Place the child safety seat on the vehicle's seat ensuring it is firmly pressed against the car seat backrest (1).

Place the child in the child safety seat (2).

Fasten the seat belt, making sure that both the sections of the seat belt webbing go under the armrest closest to the buckle. The diagonal belt goes through the red belt guide on the side of the headrest.

Check that the webbing has not become twisted and tighten the seat belt by pulling the diagonal strap upwards (3).

Slot the end of the diagonal strap over the seat belt guide in the side of the head rest and retighten (4). Make sure the seat belt has not become twisted.

Also check that the cover is not impeding the movement or fit of the seat belt webbing in any way.

REMOVING THE BACKREST

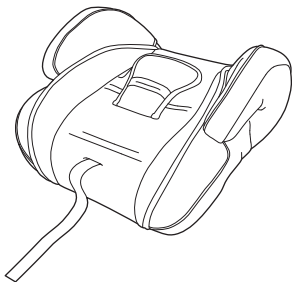
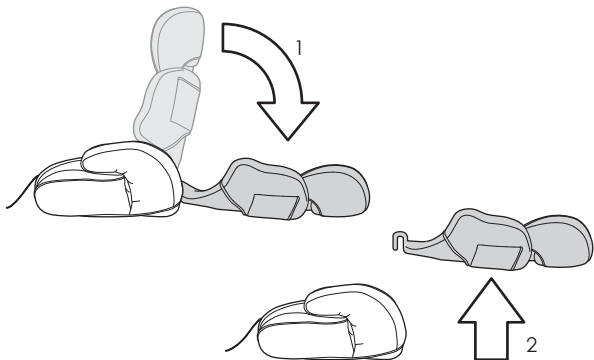

Remove the car seat from the car and lay on a clean flat surface. Push the top of the backrest downwards until it is on the floor (1). Lift the bottom of the backrest upwards until the lugs are clear of the seat (2).

Place the backrest in a safe place away from children.



FITTING THE BOOSTER SEAT 22 – 36KG (APPROXIMATELY 4 YEARS TO 11 YEARS).

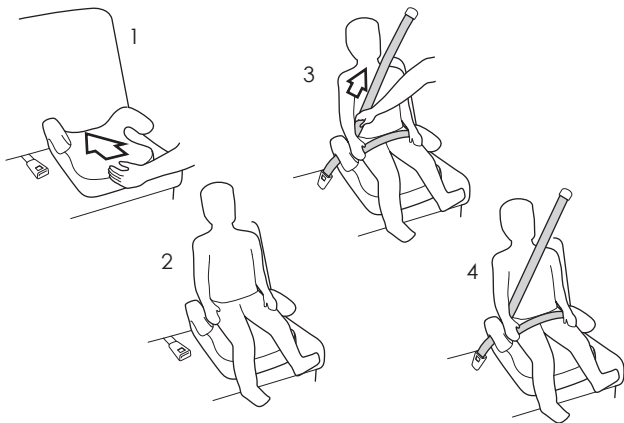

Place the booster seat on the vehicle's seat ensuring it is pushed firmly against the vehicle's seat and backrest (1).

Place the child on the booster seat (2).

Fasten the seat belt, making sure that the lap belt webbing goes under both armrests and the diagonal belt webbing goes over the armrest near the buckle. Tighten the seat belt by pulling upwards on the diagonal strap (3).

Check the seat belt to ensure there is no slack and the belt has not become twisted or trapped (4).

Check that the cover is not impeding the movement or fit of the seat belt in anyway.

To release the child, simply unfasten the seat belt in the normal manner.

CARE AND MAINTENANCE

These instructions are important. Please read carefully and retain for future reference.

Backrest cover removal: First release the elastic strap at the bottom of the backrest cover. Slide the cover off. The cover can now be cleaned.

Headrest, booster seat cover removal: Slide the cover off. The cover can now be cleaned.

Washing the covers: The covers should be hand washed using a mild soap and warm water. Do not use chemicals and never attempt to bleach or dye the webbing. Allow to dry naturally.

IMPORTANT Note:

The seat restraint must not be used without the cover.

The seat cover should only be replaced with one recommended by the manufacturer, because the cover constitutes an integral part of the restraint's performance.

Do not use the car seat after an impact or accident.



Please remove the car seat from the vehicle when it is not used and keep out of reach of your child.

Please always fasten the car seat when it is inside the vehicle.

Please always read the manual before using it. The manual is in the pocket located on the back of the cover.

1. This is a “Universal” child restraint, it is approved to ECE Regulation 44.04 for general use in vehicles and will fit most, but not all vehicle seats.
2. A correct fit is likely if the vehicle manufacturer has declared in the vehicle handbook that the vehicle is capable of accepting a “Universal” child restraint of this group.
3. This child restraint has been declared “Universal: under more stringent conditions than those applied to earlier designs which do not carry this notice.
4. If in any doubt, consult either the child restraint manufacturer or the retailer.
5. Keep the seat covered when the weather is hot as the buckle and other metal objects may become hot.

6. Do not allow the seat to come into contact with corrosive chemicals etc.

Only suitable if the vehicle is fitted with 3-point static, 3-point retractor safety belts, approved to UN/ECE Regulation no. 16 or other equivalent standards.

EXTREME HAZARD

Do not use in passenger seats equipped with air bags (SRS)

What's the law on car seats?

The law states that you must use a car seat from birth until your child reaches either 135cm in height or 12 years of age — whichever comes first.

It is the driver's responsibility to make sure that children under the age of 14 are restrained correctly.



Ladybird

Manufactured for:
Shop Direct Home Shopping Limited
Skyways House
Speke Road
L70 1AB
UK

